

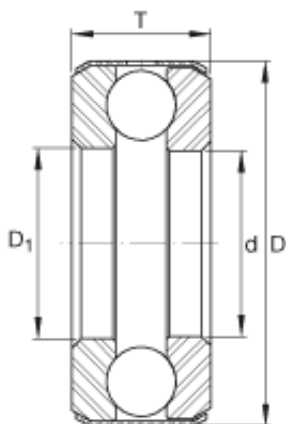

PRECISION AXLE CORP.



B39 Bearing 2D drawings and 3D CAD models

GATES B39 high quality B type wrapped v belt for brazil market

Bearing No. B39

Size	74.613x116.69x28.58 mm
Bore Diameter	74,613 mm
Outer Diameter	116,69 mm
Width	28,58 mm
d	2 15/16 inch
d	74,613 mm
D	4,594 inch
D	116,69 mm
T	1,125 inch
T	28,58 mm
D ₁	2,969 inch
m	2,428 lbs / Weight
m	1,101 kg / Weight
C _a	21400 lbf / Dynamic load rating (axial)
C _a	95000 N / Dynamic load rating (axial)
C _{0a}	57000 lbf / Static load rating (axial)
C _{0a}	254000 N / Static load rating (axial)
Category	Thrust Ball Bearing
Inventory	0.0
Manufacturer Name	SCHAEFFLER GROUP
Minimum Buy Quantity	N/A
Weight / Kilogram	1.318
Product Group	B00308



PRECISION AXLE CORP.

Rolling Element	Ball Bearing
Thrust Bearing	Yes
Single or Double Direction	Single Direction
Banded	Yes
Cage Material	Steel
Precision Class	ABEC 1 ISO P0
Component Description	Roller Assembly Plus Raceways
Other Features	Single Row With Flat Seat
Long Description	2-15/16" Bore 1; 2-31/32" Bore 2; 4-19/32" Outside Diameter; 1-1/8" Height; Ball Bearing; Single Direction; Banded; Steel Cage; ABEC 1 ISO P0 Precision
Inch - Metric	Inch
Category	Thrust Ball Bearings
UNSPSC	31171552
Harmonized Tariff Code	8482.10.50.08
Noun	Bearing
Keyword String	Ball Thrust
Manufacturer URL	http://www.ina.com
Bore 1	2.938 Inch 74.625 Millimeter
Bore 2	2.969 Inch 75.413 Millimeter
Overall Height with Aligning Washer	0 Inch 0 Millimeter
Height	1.125 Inch 28.575 Millimeter
Outside Diameter	4.594 Inch 116.688 Millimeter